

### Typical Applications

- Quarter turn application such as AMOT G valve, ball, butterfly, plug valves and dampers.

### Features and Benefits

- Self-locking gearbox prevents any valve movement in the event of actuator power failure.
- Manual override fitted as standard—valve can be operated in event of power failure.



EC050



EC100, EC300



EC600

### EC050

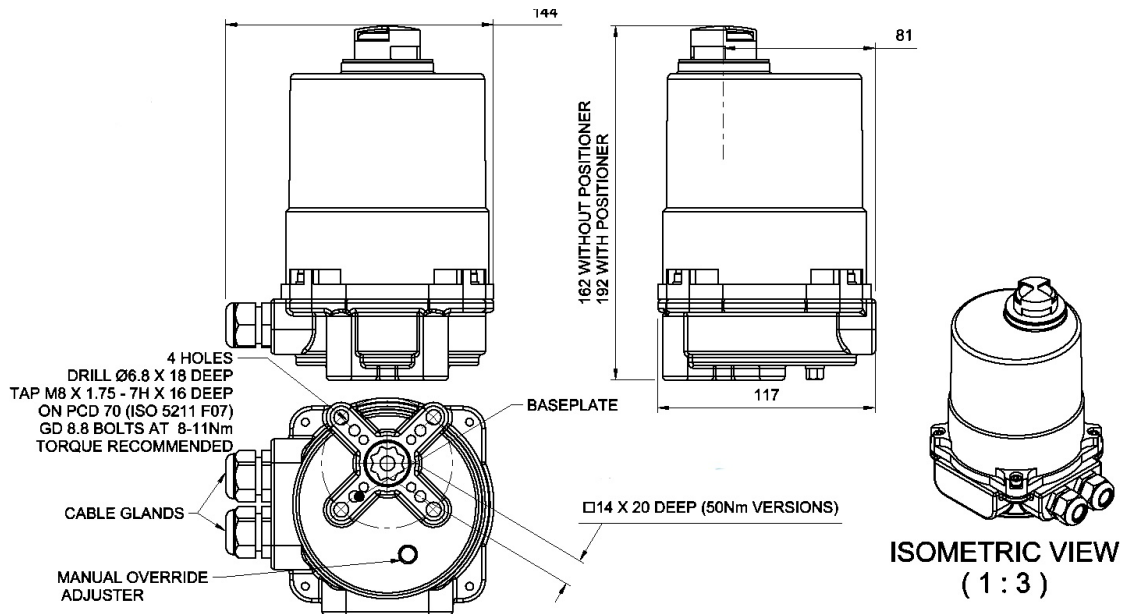

### EC100, EC300

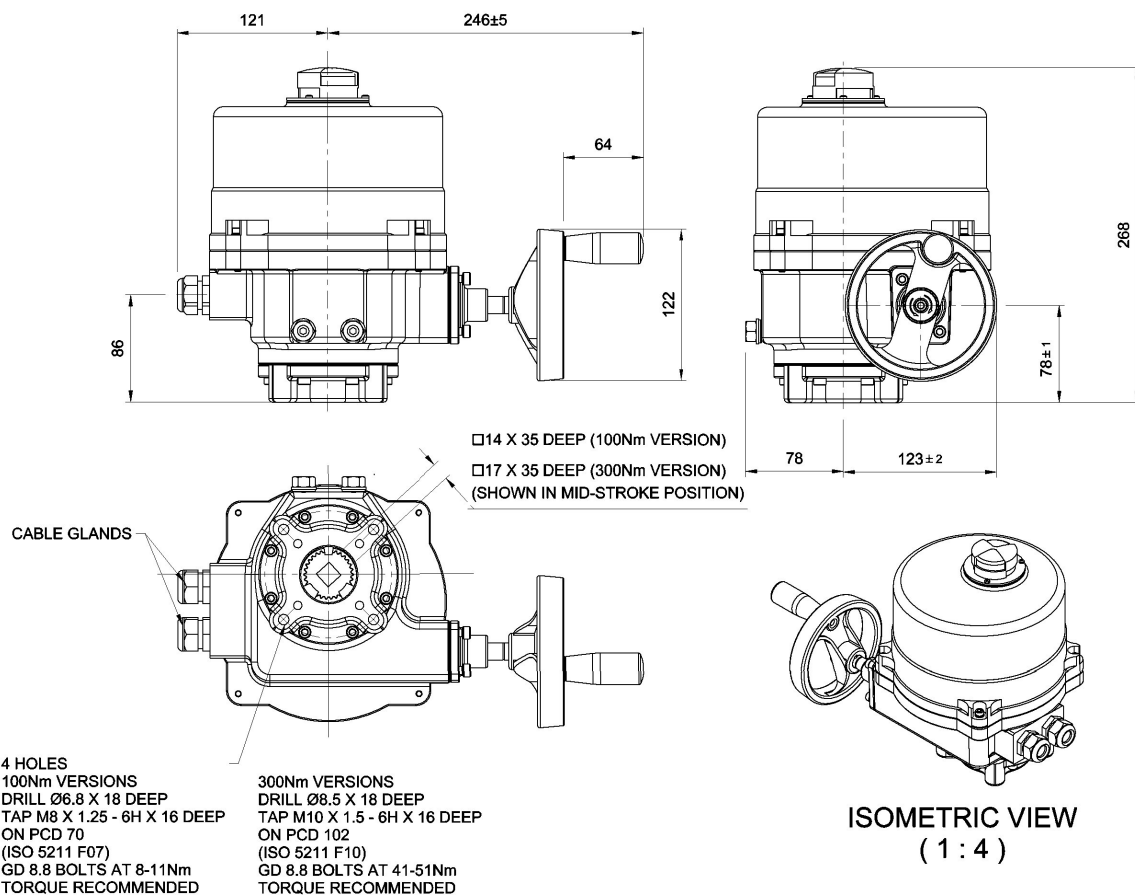

EC600

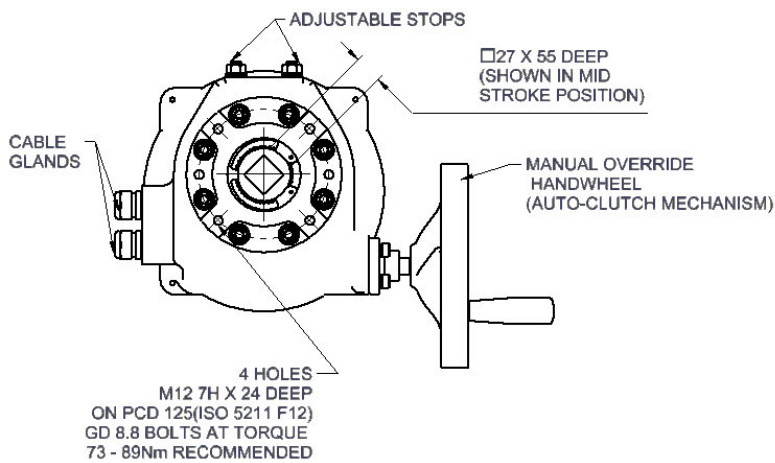
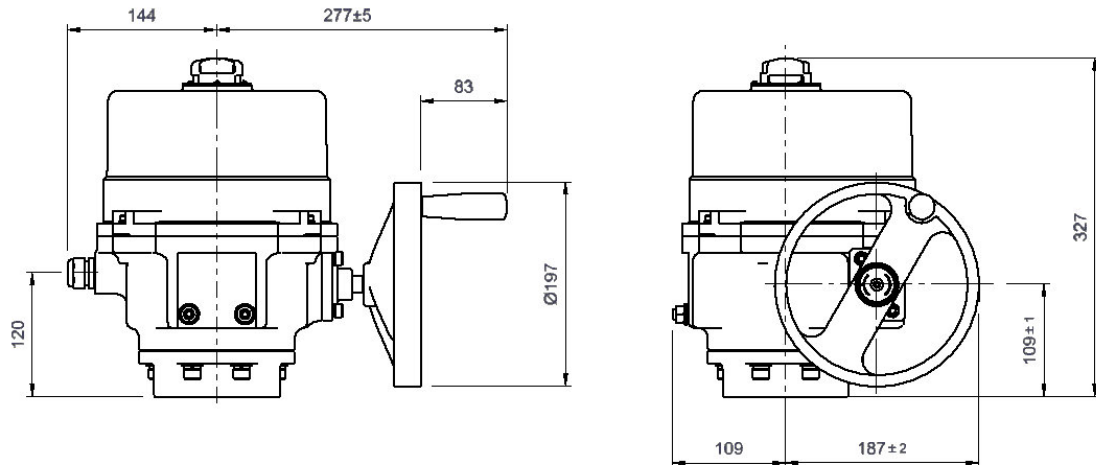

ISOMETRIC VIEW (1:4)

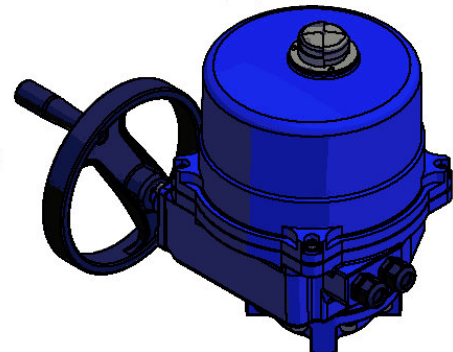

**Optional positioner**

Current or voltage actuator position control (0 to 90 degrees). Solid State motor drive. Demand signal failure can be specified as stationary or move to 4mA (0V) or 20mA (10V) ends. Input 4-20mA, 1-5V, 2-10V, 0-5V or 0-10V. Output 4-20mA.



### Specifications

<b>Power</b>	110V AC ± 10% 220V AC ± 10% 380V AC ± 10% 24V DC ± 10%	50/60 Hz single phase 50/60 Hz single phase 50/60 Hz 3 phase
<b>Limit switches</b>	Two open/close SPDT	250V AC, 10A
<b>Motor thermal protection</b>	Open 135°C nominal	
<b>Angular rotation</b>	96° max	Quarter turn
<b>Conduit entry</b>	EC050: PG13.5 (6.0-12.0 mm cable) EC100, EC300, EC600: PG16 (10.0-14.0 mm cable)	
<b>Mechanical stop</b>	Two adjustable screws (EC100, EC300, EC600)	
<b>Manual override</b>	Automated declutching mechanism (EC100, EC300, EC600)	
<b>Materials</b>	Steel, aluminium alloy, aluminium bronze, polycarbonate	
<b>External coating</b>	Dry powder polyester	
<b>Weatherproof enclosure</b>	IP67, NEMA 4 and 6	
<b>Ambient temperature</b>	-20°C to +70°C	
<b>Ambient humidity</b>	90% RH max (noncondensing)	
<b>Anti-condensation heater</b>	7 - 15W	
<b>Mounting orientation</b>	Can be mounted up to ±90 degrees from upright	

### Performance

Model	Max output torque	Stroke time (seconds)		Max current			
		50/60 Hz	DC	380	220V	110V	24V
EC050	50 Nm	15	10	NA	0.32A	0.54A	1.35A
EC100	100 Nm	19	14	0.45A	0.63A	1.4A	4.8A
EC300	300 Nm	39	28	0.45A	0.69A	1.47A	5.25A
EC600	600 Nm	39	20	0.62A	1.0A	1.9A	5.6A

### Mechanical

Model	Weight	Mounting		Drive Interface ISO 5211	
		PCD (mm)	Thread		
EC050	3 kg	70	M8	14 mm square	F07
EC100	11 kg	70	M8	14 mm square	F07
EC300	11 kg	102	M10	17 mm square	F10
EC600	22 kg	125	M12	27 mm square	F12

### Defining Actuator Part Number

Use the tables below to select any required specifications of your EC actuator. Please select one characteristic from each section. Each characteristic is associated with a code that you will need to state when ordering.

Example: EC100220E-AA

Actuator Type	Code	✓
EC actuator	EC	

Size/nominal torque	Code	✓
50 Nm	050	
100 Nm	100	
300 Nm	300	
600 Nm	600	

Supply voltage	Code	✓
24V DC	024	
115V AC	110	
230V AC	220	
380V AC	380	

Features	Code	✓
Switched live, no positioner.	0	
With positioner, 4-20mA Input, 4-20mA Output, Direct acting, upon loss of signal default to 4mA position.	A	
As "A" but upon loss of signal default to 20mA position.	B	
As "A" but upon loss of signal actuator does not move.	C	
As "A" but reverse acting.	E	

Features (continued)	Code	✓
As "E" but upon loss of signal default to 20mA position.	F	
As "E" but upon loss of signal actuator does not move.	G	
With positioner, 0-10V Input, 0-10V Output, Direct acting, upon loss of signal default to 0V position.	H	
As "H" but upon loss of signal default to 10V position.	I	
As "H" but upon loss of signal actuator does not move.	J	
As "H" but reverse acting. Upon loss of signal default to 0V position.	K	
As "K" but upon loss of signal default to 10V position.	L	
As "K" but upon loss of signal actuator does not move.	M	

Special requirements	Code	✓
Standard	-BMF	
Notes		

#### Americas

AMOT - USA  
 Tel +1 888 566 AMOT  
 Fax +1 (713) 559 9419  
 customer.service@amot.com

AMOT - Canada  
 Tel +1 888 566 AMOT  
 Fax +1 (780) 469 6275  
 customer.service@amot.com

#### Asia Pacific

AMOT - China  
 Tel +86 21 5910 4052  
 Fax +86 21 5910 4050  
 shanghai@amot.com

#### Europe, Middle East and Africa

AMOT - United Kingdom  
 Tel +44 (0) 1284 715739  
 Fax +44 (0) 1284 760256  
 info@amot.com

AMOT - Germany  
 Tel +49 (0) 40 8537 1298  
 Fax +49 (0) 40 8537 1331  
 germany@amot.com

[www.amot.com](http://www.amot.com)